

CURRENT CLAMPS FOR AC CURRENT



B series

The only model in the B series, the B102 is designed to measure earth leakage currents caused by insulation faults.

It enables the fault to be located and diagnosed before failure occurs thus avoiding installation shutdown.

It is designed specifically for locating low-current faults on high-current circuits.

The B102 measures differential or leakage current from 500 μ A upwards and may be used to measure currents up to 400 A in continuous use (400 A max.). The B102 has 2 measurement ranges, 1 mV / mA or 1 mV / A.

As a leakage current detector, the B102 can be used on single or multiphase systems whether the currents are in or out of phase, balanced or unbalanced.

The B102 may be used simply as a high-precision clamp-on current probe.

With its 115 mm jaw opening and dynamic measurement range from 500 μ A to 400 A, the B102 is a versatile instrument, highly useful in the analysis of unbalanced circuits, leakage currents and earth loop currents.

CURRENT CLAMPS FOR AC CURRENT

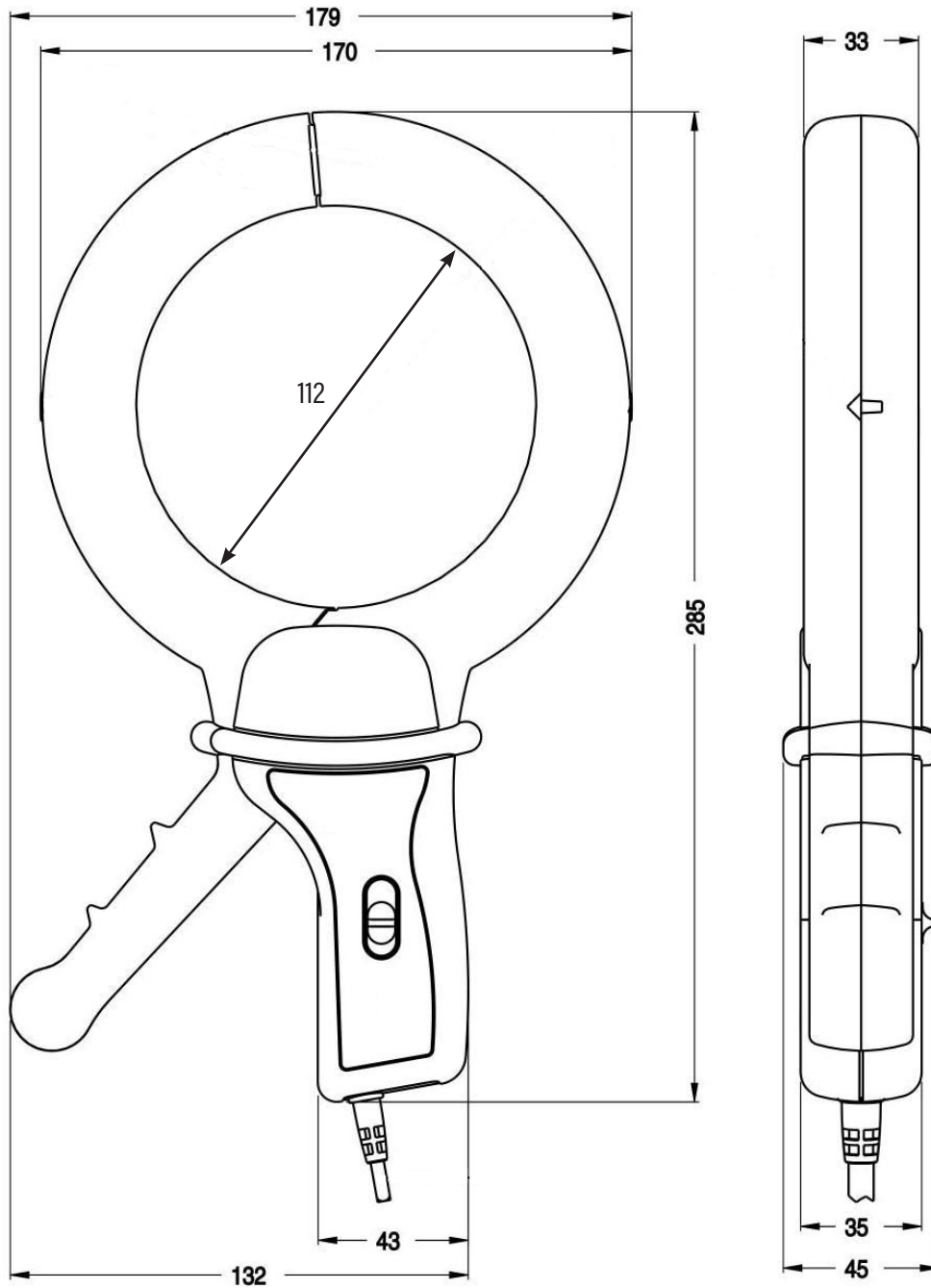

CURRENT CLAMPS FOR AC CURRENT

Model B102 (probe for leakage currents)

Current	4 A AC	400 A AC
Output	1 mV / mA	1 mV / A

Description

The B102 clamp measures leakage currents or residual currents as low as 500 μ A and can be used with multimeters equipped with a calibre in mV AC.

The B102 clamp measures the currents flowing in earth loops as well as leakage currents. It can be used on live installations to detect insulation faults on the earth circuits of single and three-phase networks.

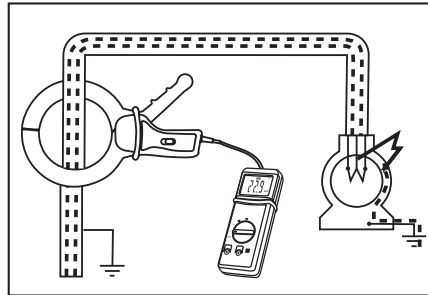

Electrical specifications

- Current range:**
0.5 mA AC .. 4 A AC
0.5 A AC .. 400 A AC
- Output signal:**
1 mV AC / mA AC (4 V for 4 A)
1 mV AC / A AC (0.4 V for 400 A)
- Accuracy and phase shift ⁽¹⁾:**

Calibre	4 A		
Primary current:	0.5 mA .. 10 mA	10 mA .. 100 mA	100 mA .. 4 A
Accuracy in % of output signal	$\leq 3\% + 1\text{ mV}$	$\leq 0.5\% + 0.5\text{ mV}$	$\leq 0.5\% + 0.5\text{ mV}$
Phase shift	Not specified	$\leq 15^\circ$	$\leq 10^\circ$

Calibre	400 A		
Primary current:	0.5 mA .. 10 A	10 A .. 200 A	200 A .. 400 A
Accuracy in % of output signal	$\leq 0.5\% + 0.5\text{ mV}$	$\leq 0.35\% + 0.5\text{ mV}$	$\leq 0.35\% + 0.5\text{ mV}$
Phase shift	Not specified	$\leq 1^\circ$	$\leq 0.7^\circ$

- Bandwidth:**
30 Hz .. 1 kHz (depending on current value)
- Maximum currents:**
400 A AC continuous for a frequency ≤ 1 kHz
Peak current < 1,000 A
- Load impedance:**
 $\geq 10\text{ M}\Omega / 100\text{ pF}$
- Max. voltage output:**
Electronic protection circuit limiting voltage to 6 V peak max.
- Influence of temperature:**
Measurement: $\leq 100\text{ ppm / K}$ or 0.1 % of output signal per 10 °K
- Influence of adjacent conductor:**
0.4 mA/A typical at 50 Hz
- Influence of an external field:**
For a perpendicular external field of 400 A/m at 50 Hz
 - 4 A calibre: $\leq 60\text{ mA}$
 - 400 A calibre: $\leq 0.1\text{ A}$
- Influence of conductor position in jaws:**
 $\leq 0.1\%$ of the reading at 50/60 Hz (non-residual current)
 $\leq 0.2\%$ of the reading at 50/60 Hz (residual current)
- Influence of DC current superimposed on rated current AC:**
for a current DC from 1 A
 - 4 A calibre: $\leq 1\text{ mA}$
 - 400 A calibre: $\leq 0.1\text{ A}$
- Influence of frequency:**
 - 4 A calibre: $\leq 2\%$
 - 400 A calibre: $\leq 0.5\%$ from 30 Hz to 1 kHz (limited to 100 A for 1 kHz)
- Influence of the measurement instrument's input impedance (Z_e):**
 - 4 A calibre: $E\% = [Z_e / (Z_e + 4.8) - 1] * 100$
 - 400 A calibre: $E\% = [Z_e / (Z_e + 0.0048) - 1] * 100$

Mechanical specifications

- Operating temperature:**
-10°C to +55°C
- Storage temperature:**
-40°C to +70°C
- Clamping capacity:**
Cables: $\varnothing 12\text{ mm}$
Busbars: 1 busbar 20 x 50 mm
- Casing protection rating:**
IP40 with clamp closed (NF EN60529 Ed. 95)
IP30 with jaws open
- Relative humidity for operation:**
0 to 85 % RH with a linear decrease above 35 °C
- Operating altitude:**
0 to 2,000 m

- Drop test:**
1 m (NF EN61010-2-032)
- Self-extinguishing capability:**
Casing: V0 according to UL94
Jaws: V2 according to UL94
- Dimensions:**
285 x 175 x 43 mm
- Mass:**
Approximately 1.3 kg
- Colours:**
Dark grey case with red jaws
- Output:**
Cable with double insulation, length 1.5 m, terminated by 2 insulated elbowed

Safety specifications

- Electrical safety:**
Instrument with double insulation or reinforced insulation between the primary, the secondary and the grippable part located under the guard as per EN 61010-1 Ed. 2: 2001, EN 61010-2-031 Ed. 2002 & EN 61010-2-032 Ed. 2003
 - 600 V category III, pollution degree 2
 - 300 V category IV, pollution degree 2
- Electromagnetic compatibility:**
EN 50081-1: class B
EN 50082-2:
 - CE-certified equipment compliant with standard EN61326-1 (Ed. 97) + A1 (Ed. 98) + A2 (Ed. 01)
 - Emission: stipulations for class B equipment (domestic use).
 - Immunity: regulations for equipment operated intermittently on industrial sites.

CURRENT CLAMPS FOR AC CURRENT

Model B102 (probe for leakage currents)

Curves at 50 Hz

4 A calibre

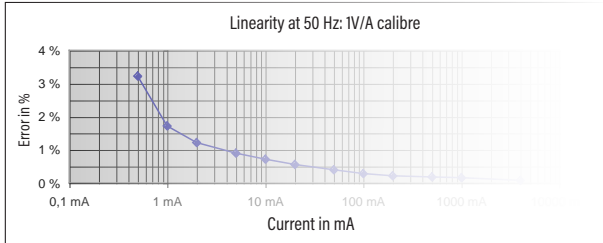

Linearity for AC

400 A calibre

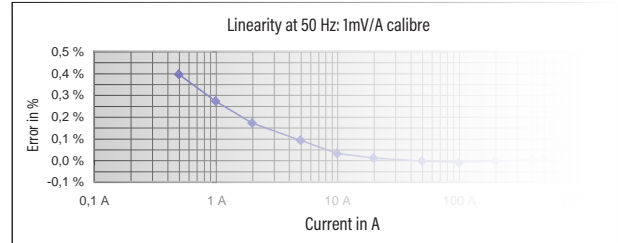

Phase shift

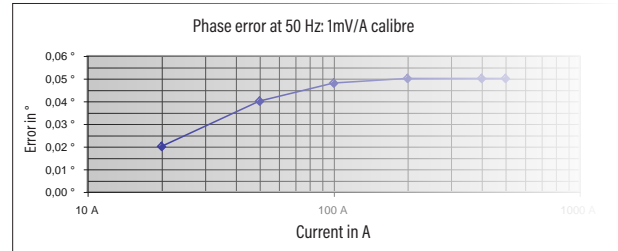
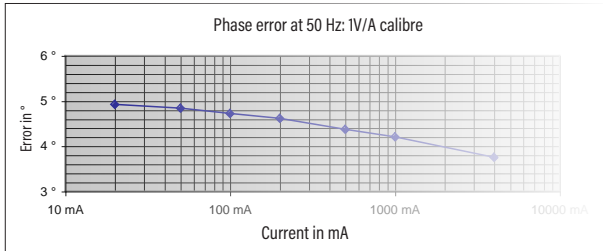

Frequency response

4 A calibre

Typical error on measurement

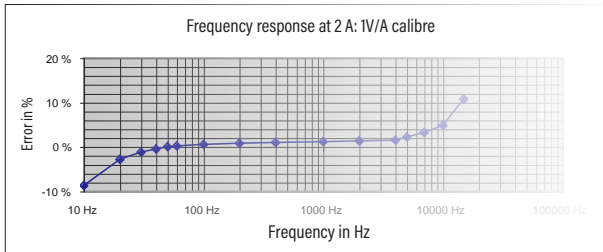

400 A calibre

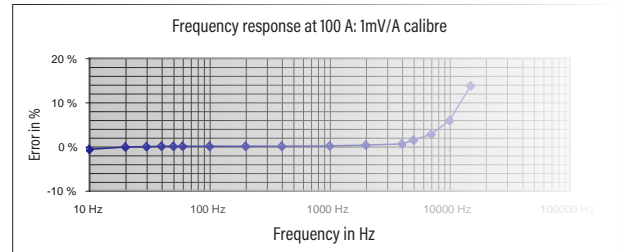

Typical phase shift

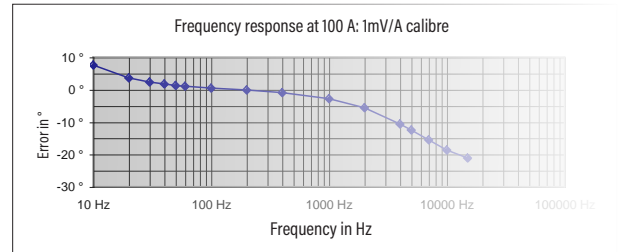
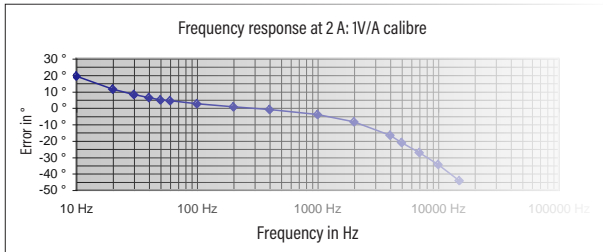

(1) Conditions of reference: 23 °C ± 3 °K, 20 % to 75 % RH, sinusoidal signal from frequency of 48 to 65 Hz, distortion factor < 1 %, no DC components, external magnetic field < 40 A/m, no AC magnetic field, no external conductor with circulating current, conductor centred for measurement, load impedance ≥ 10 MΩ / ≤ 100 pF.

To order	Reference
AC current clamp model B102 with operating manual	P01120083